



3504-10604010 2nd Posting

November 26, 2025

REQUEST FOR PRICE QUOTATION

The Civil Aviation Authority of the Philippines (CAAP) Area Center III hereby invites interested bidders for the CONSTRUCTION OF FUEL DEPOT (10,000L) AT SANGLEY AIRPORT.

Approved budget for the project – Php 738,299.40

Please secure Canvass form from www.philgeps.gov.ph or at the Regional Office, Area Center III during office hours Monday to Friday starting November 26, 2025.

The sealed quotation shall be submitted at the Civil Aviation Authority of the Philippines Regional Office, Area Center 3, Civil Aviation Complex, Clark Freeport Zone, Mabalacat Pampanga on or before December 3, 2025 at 10:00am to the Bids and Awards Committee and will be opened on the same date at 2:00pm. Indicate in the sealed envelope the name of the Project you are participating.

The CAAP Area Center III reserves the right to accept or reject any bid, and to annul the bidding process and reject all Bids at any time prior to contract award without thereby incurring any liability to the affected Bidder/s.

You may call CAAP Area Center III BAC Secretariat Members at 0282464988 local 2258 for details.

Very truly yours,

ATTY. ROAN JILLE HABOC
BAC Chairperson



Republic of the Philippines

CIVIL AVIATION AUTHORITY OF THE PHILIPPINES

REQUEST FOR QUOTATION

Date : _____

APP Item No : 3504-10604010

Company/Business Name: ¹ _____

Address: _____

Business/Mayor's Permit No.: _____

TIN: _____

PhilGEPS Registration Number (required for ABC above 50k) : _____

The **Civil Aviation Authority of the Philippines - AreaCenter III**, through its Bids and Awards Committee (BAC), intends to procure the **Construction of Fuel Depot (10,000L) at Sangley Airport** through **Section 53.9 (Negotiated Procurement - Small Value Procurement)** of the 2016 Revised Implementing Rules and Regulations of Republic Act No. 9184.

Please quote your **best offer** for the item/s described herein, subject to the Terms and Conditions provided on this Request for Quotation (RFQ). Submit your quotation duly signed by you or your duly authorized representative **not later than the deadline on December 03, 2025 at 10:00 a.m.**

Document	Remarks
Copy of 2025 Mayor's or Business Permit	Valid 2025 Mayor's or Business Permit.
Original Notarized Omnibus Sworn Statement (GPPB-Prescribed Form) (For	In the prescribed template. Downloadable at: https://www.gppb.gov.ph/wp-content/uploads/2023/06/Omnibus-Sworn-Statement-Revised.docx
PhilGEPS Registration Certificate (For ABCs above P50k)	Valid PhilGEPS Certificate of Registration (COR).
PCAB License (For ABCs above P50k if applicable for Repair & Maintenance and Infrastructure)	Valid PCAB License.
Latest Annual Income / Business Tax Return (For ABCs above P500k)	Annual Income Tax Return from previous year must be submitted.



Performance Security (for ABCs above P50k)	Once the Notice of Award of the Project is given, the winning bidder is required to submit Performance Security prior to the signing of the contract as prescribed by Section 39 of Updated 206 Revised IRR of RA 9184 to wit:	
	Form of Performance Security	Amount of Performance Security (Not less than the required percentage of the Total Contract Price)
	a.) Cash or cashier's/manager's check issued by a Universal or Commercial Bank. For biddings conducted by LGUs, the cashier's/manager's check may be issued by other banks certified by the BSP as authorized to issue such financial instrument. (a)	
	b.) Bank draft/guarantee or irrevocable letter of credit issued by a Universal or Commercial Bank: Provided, however, That is shall be confirmed or authenticated by a Universal or Commercial Bank, if issued by a foreign bank. For biddings conducted by LGUs, bank draft/guarantee, or irrevocable letter of credit may be issued by other banks certified by the BSP as authorized to issue such financial instrument. (a)	Goods and Consulting Services – Five percent (5%) Infrastructure Projects - Ten percent (10%)
	c.) Surety bond callable upon demand issued by a surety or insurance company duly certified by the Insurance Commission as authorized to issue such security.	Thirty percent (30%)
Non-submission of Performance Security shall warrant disqualification of bids as mandated by Section 40 of Updated 2016 Revised IRR of RA 9184.		

For any clarification, you may contact us at telephone no. **(045) 499-1663** or email address at **bac_area3@caap.gov.ph**.

ROAN JILL E. HABOC
BAC Chairperson

¹ In case of discrepancy on the business name as reflected on this RFQ and as reflected in the Business Permit, the latter shall prevail.

INSTRUCTIONS:

Note: Failure to follow these instructions will disqualify your entire quotation.

- (1) Do not alter the contents of this form in any way.
- (2) The use of this RFQ is **highly encouraged** to minimize errors or omissions of the required mandatory provisions. In case of any changes, bidders must use or refer to the latest version of the RFQ, except when the latest version of the RFQ **only** pertains to deadline extension.

If another form is used other than the latest RFQ, the quotation shall contain all the mandatory requirements/provisions including manifestation on the agreement with Terms and Conditions below.

In case a prospective supplier/service provider submits a filled-out RFQ with a supporting document (i.e., a price quotation in a different format), both documents shall be considered unless there will be discrepancies. In this case, provisions in the RFQ shall prevail.
- (3) **All mandatory technical specifications (with asterisk) must be complied with.** Failure to comply with the mandatory requirements shall render the quotation ineligible/disqualified.
- (4) Quotations may be submitted through electronic mail at **bac_area3@caap.gov.ph**.
- (5) Quotations, including documentary requirements, received after the deadline shall not be accepted. For quotations submitted via electronic mail, the date and time of receipt indicated in the email shall be considered.

TERMS AND CONDITIONS:

1. Bidders shall provide correct and accurate information required in this form.
2. Any interlineations, erasures, or overwriting shall be valid only if they are signed or initialed by you or any of your duly authorized representative/s.
3. Price quotation/s must be valid for a period of thirty (30) calendar days from the deadline of submission.
4. Price quotation/s, to be denominated in Philippine peso, shall include all taxes, duties, and/or levies payable.
5. Quotations exceeding the Approved Budget for the Contract shall be rejected.
6. In case of two or more bidders are determined to have submitted the Lowest Calculated Quotation/Lowest Calculated and Responsive Quotation, CAAP Area Center III shall adopt and employ "draw lots" as the tie-breaking method to finally determine the single winning provider in accordance with GPPB Circular 06-2005.
7. Award of contract shall be made to the lowest quotation which complies with the technical specifications, requirements and other terms and conditions stated herein.
8. The item/s shall be delivered according to the accepted offer of the bidder.
9. Item/s delivered shall be inspected on the scheduled date and time of the CAAP Area Center III. The delivery of the item/s shall be acknowledged upon the delivery to confirm compliance with the technical specifications
10. Payment shall be made after delivery and upon the submission of the required supporting documents, i.e., Order Slip and/or Billing statement, by the supplier, contractor, or consultant. Our Government Servicing Bank, i.e., the Land Bank of the Philippines, shall consultant not earlier than twenty-four (24) hours, but not later than forty-eight (48) hours, upon receipt of our advice. Please note that the corresponding bank transfer fee, if any, shall be chargeable to the account of the supplier, contractor, or consultant.



11. Liquidated damages equivalent to one-tenth of one percent (0.1%) of the value of the goods/ services/equipment not complied/delivered within the prescribed delivery period shall be imposed per day of delay. The CAAP Area Center III may terminate the contract once the cumulative amount of liquidated damages reaches ten percent (10%) of the amount of the contract, without prejudice to other courses of action and remedies open to it.
12. All transactions are subject to withholding of credible Government Taxes per revenue regulation(s) of the Bureau of Internal Revenue.
13. For first time bidder, you are required to submit a portfolio of manpower and equipment of your company.
14. Upon Post Qualification, the Winning Bidder, must also submit Tax receipts from Bureau of Customs as proof of payment of all taxes and duties due on the equipment, if the said equipment was bought outside the Philippines.

After having carefully read and accepted the Instructions and Terms and Conditions, I/we submit our quotation/s for the item/s as follows:

Construction of Fuel Depot (10,000L) at Sangley Airport				
<i>Complete Descriptions of Articles</i>	<i>Qty</i>	<i>Unit</i>	<i>Unit Price</i>	<i>Total Amount</i>
Civil/Structural Works				
Demolition Works	1.00	lot		
A. Materials	-	-		
B. Labor	<i>Qty</i>	<i>No. of Days</i>		
Construction Foreman	1.00	2.00		
Common Worker	2.00	2.00		
C. Equipment	<i>Qty</i>	<i>No. of Days</i>		
Jackhammer	2.00	1.00		
Concrete Saw (7.5hp)	1.00	1.00		
Demolition Works Labor Cost				
Demolition Works Equipment Cost				
Demolition Works Direct Cost				
Concrete Works				
A. Materials				
40kg Portland Cement	46.00	bag/s		
Sand	3.00	cu.m		
3/4" Gravel	5.00	cu.m		
1/2" x 4' x 8' Ordinary Plywood	3.00	pcs		
Form Lumber	48.00	bd. ft.		
Assorted CWN	3.15	kgs		
B. Labor	<i>Qty</i>	<i>No. of Days</i>		
Construction Foreman	1.00	2.00		
Skilled Worker	2.00	2.00		
Common Worker	4.00	2.00		
C. Equipment	<i>Qty</i>	<i>No. of Days</i>		
One-bagger Concrete Mixer	1.00	2.00		
Concrete Vibrator	1.00	2.00		
Concrete Works Material Cost				
Concrete Works Labor Cost				
Concrete Works Equipment Cost				
Concrete Works Direct Cost				
Rebars Works	<i>Qty</i>	<i>Unit</i>		
A. Materials				
12mm dia. DRSB, 6 meters	70.00	pcs		
Official Copy				



#16 GI Tie Wire	8.00	kg	
B. Labor	Qty	No. of Days	
Construction Foreman	1.00	1.00	
Skilled Worker	2.00	1.00	
Common Worker	4.00	1.00	
Rebar Works Material Cost			
Rebar Works Labor Cost			
Rebar Works Direct Cost			
Structural Steel Works	Qty	Unit	
A. Materials			
4" x 4" x 3.00mm Tubular Steel, 6m	3.00	pcs	
2" x 4" x 3.00mm Tubular Steel, 6m	3.00	pcs	
2" x 4" x 1.5mm Tubular Steel, 6m	15.00	pcs	
2" x 2" x 1.5mm Tubular Steel, 6m	14.00	pcs	
Welding Rod	15.00	kg	
16mm Anchor Bolt w/ nuts & washers	24.00	pcs	
Injectable Structural Epoxy Resin	1.00	cartridge	
Grinding Disc	25.00	pcs	
Metal Cutting Disc	25.00	pcs	
B. Labor	Qty	No. of Days	
Construction Foreman	1.00	4.00	
Skilled Worker	2.00	4.00	
Common Worker	2.00	4.00	
C. Equipment	Qty	No. of Days	
Welding Machine, 300Amp	1.00	4.00	
Structural Steel Works Material Cost			
Structural Steel Works Labor Cost			
Structural Steel Works Equipment Cost			
Structural Steel Works Direct Cost			
Structural Steel Works (Purlins)	Qty	Unit	
A. Materials			
50" x 100" x 1.2mm C-Purlins, 6m	16.00	pcs	
Welding Rod	5.00	kg	
Grinding Disc	5.00	pcs	
Metal Cutting Disc	8.00	pcs	
B. Labor	Qty	No. of Days	
Construction Foreman	1.00	1.00	
Skilled Worker	1.00	1.00	
Common Worker	1.00	1.00	
C. Equipment	Qty	No. of Days	
Welding Machine, 300Amp	1.00	4.00	
Structural Steel Works (Purlins) Material Cost			
Structural Steel Works (Purlins) Labor Cost			
Structural Steel Works (Purlins) Equipment Cost			
Structural Steel Works (Purlins) Direct Cost			
Structural Steel Works (Steel Plates)	Qty	Unit	
A. Materials			
Steel Plates (Mild Steel)	1750.00	kg	
Welding Rod	5.00	kg	
Oxygen	2.00	cyl	
Acetylene	2.00	cyl	
Grinding Disc	25.00	pcs	
Metal Cutting Disc	25.00	pcs	

Official
Copy



B. Labor	Qty	No. of Days	
Construction Foreman	1.00	3.00	
Skilled Worker	2.00	3.00	
Common Worker	2.00	3.00	
C. Equipment	Qty	No. of Days	
Welding Machine, 300Amp	1.00	1.00	
Oxy-Acetylene Cutting Torch/Welding Outfit	1.00	1.00	
Structural Steel Works (Steel Plates) Material Cost			
Structural Steel Works (Steel Plates) Labor Cost			
Structural Steel Works (Steel Plates) Equipment Cost			
Structural Steel Works(Steel Plates) Direct Cost			
Architectural Works	Qty	Unit	
Prepainted Metal Accessory (Ridge Roll)			
A. Materials			
Prepainted Ridge Rolls, 0.6mm thk.	4.00	pcs	
Blind Rivet	1.00	box	
B. Labor	Qty	No. of Days	
Construction Foreman	1.00	1.00	
Skilled Worker	1.00	1.00	
Common Worker	1.00	1.00	
Prepainted Metal Accessory (Ridge Roll) Material Cost			
Prepainted Metal Accessory (Ridge Roll) Labor Cost			
Prepainted Metal Accessory (Ridge Roll) Direct Cost			
Prepainted Metal Sheets (0.6mm thk., Rib Type)	Qty	Unit	
A. Materials			
Prepainted Metal Sheets (0.6mm thk., Rib Type)	53.50	sq.m.	
Tek Screw	485.00	pcs	
B. Labor	Qty	No. of Days	
Construction Foreman	1.00	1.00	
Skilled Worker	1.00	1.00	
Common Worker	2.00	1.00	
Prepainted Metal Sheets (0.6mm thk., Rib Type) Material Cost			
Prepainted Metal Sheets (0.6mm thk., Rib Type) Labor Cost			
Prepainted Metal Sheets (0.6mm thk., Rib Type) Direct Cost			
Painting Works	Qty	Unit	
A. Materials			
<i>Metal Painting</i>			
Red Oxide Primer	4.00	gals.	
Ename Paint	9.00	gals.	
Paint Thinner	20.00	liters	
Paint Roller with pan 9"	1.00	set	
Paint Brush, 4"	2.00	pcs	
Paint Brush, 2"	2.00	pcs	
Rugs	5.00	kgs	
B. Labor	Qty	No. of Days	
Construction Foreman	1.00	5.00	
Skilled Worker	2.00	5.00	
Common Worker	1.00	5.00	
Painting Works Material Cost			
Painting Works Labor Cost			
Painting Works Direct Cost			
Steel Matt Wall and Door Including Paint	Qty	Unit	
A. Materials			
4.5mm, 2" x 2" Steel Matting (4" x 8")	20.00	pcs	
Welding Rod	1.50	kg	

Red Oxide Primer	1.00	gals.		
Ename Paint	2.00	gals.		
Paint Thinner	3.50	liters		
Grinding Disc	2.00	pcs		
Metal Cutting Disc	5.00	pcs		
Paint Brush, 4"	1.00	pcs		
Paint Brush, 2"	1.00	pcs		
Rugs	3.00	kgs		
B. Labor	Qty	No. of Days		
Skilled Worker	1.00	3.00		
Common Worker	1.00	3.00		
Steel Matt Wall Material Cost				
Steel Matt Wall Labor Cost				
Steel Matt Wall Direct Cost				
Electrical Works	Qty	Unit		
Lighting and Power Conduits and Fittings				
A. Materials				
20mm dia. uPVC pipe sch. 40 orange color (1m/linear meters refer to installed length and must already include costing of piping accessories and items needed for installation)	21.00	1m		
55mm x 100mm Octagonal box Galv. Ga. 18 with 15 % 20 mm concentric knockout	1.00	pc		
Ceiling Type Receptacle	2.00	pcs		
3.5 square mm THHN cu. Wire 600 Volt	50.00	1m		
One Way, One Pole, Two Gang Switch, 16A, 250V, with White Color Faceplate wide series	2.00	set		
1 set 30A Circuit Breaker	1.00	pc		
Day-light Buld, 15 Watts	2.00	pcs		
Consumables (Butane, Cutting Discs, Drill Bits, Electrical Tapes, and other necessary items to be consumed.)	1.00	lot		
B. Labor	Qty	No. of Days		
Construction Foreman	1.00	2.00		
Skilled Worker	1.00	2.00		
Common Worker	1.00	2.00		
Electrical Works Material Cost				
Electrical Works Labor Cost				
Electrical Works Direct Cost				
Mechanical Works	Qty	Unit		
A. Materials (Supply and Install)				
Fuel Tank & Electrical Fuel Pump				
Fuel Tank				
10,000 Liter Capacity fuel tank fabricated with 6.00mm SM Plate 3.9m in length, 1.9m inside diameter including built in metal stand, steel tank ladder and 3/4 transparent hose indicator. Including also painting, plant leaktest and/pneumatic test report, delivery, lifitng services and installation.	1.00	set		

Fuel Pump			
Electric Fuel Pump (0.75hp)	1.00	set	
Fuel Tank & Electrical Fuel Pump Material Cost			
Fuel Tank & Electrical Fuel Pump Direct Cost			
Piping System	Qty	Unit	
Piping System	1	lot	
A. Materials			
1" Fuel/Hydraulic Hose	35.00	lm	
1" Check Valve	4.00	pcs	
1" Tee	2.00	pcs	
1" Threaded Adaptor	7.00	pcs	
1" Fuel Tank Cap Adaptor	2.00	pcs	
1" Stainless Steel Hose Clamp	32.00	pcs	
2" PVC Orange Pipe	5.00	pcs	
2" PVC Orange Pipe	5.00	pcs	
Miscellaneous			
Consumables (Bolts and Nuts, Hangers and Supports, Brakcet, Paint, and other necessary things to complete the system.)	1.00	lot	
B. Labor			
	Qty	No. of Days	
Construction Foreman	1.00	4.00	
Skilled Worker	1.00	4.00	
Common Worker	1.00	4.00	
Piping System Material Cost			
Piping System Labor Cost			
Piping System Direct Cost			
Total Equipment Cost			
Total Labor Cost			
Total Material Cost			
Total Direct Cost			

FINANCIAL OFFER:

Terms of Payment:

Payment shall be made upon completion of all required documents, inspection and acceptance of the end user if needed. Please provide the following bank details.

Payment Details:

Name of Payee: _____
TIN: _____

Please quote your total best offer for the item/s above. Please do not leave any blank items. Indicate "0" if item being offered is for free.

Construction of Fuel Depot (10,000L) at Sangley Airport
Approved Budget for the Contract: Seven Hundred Thirty Eight Thousand Two Hundred Ninety Nine & 40/100 Pesos Only
P 738,299.40
TOTAL OFFERED QUOTATION
In Words:
In Figures:

Canvassed By:

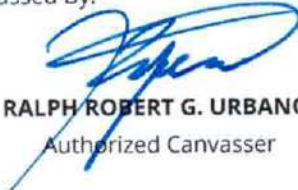
RALPH ROBERT G. URBANO
Authorized Canvasser

Signature over Printed Name

Position/Designation

Office Telephone/Fax/Mobile Nos.

Email address/es





SCOPE OF WORK

I. GENERAL

The contractor shall furnish, labor, materials and equipment to complete the **Construction of Fuel Depot (10,000L) at Sangley Airport**.

II. LOCATION OF PROJECT

The Contract to be bid is located at **Sangley point Airport, Cavite City, Cavite**.

III. SCOPE OF WORK

The project covers the supply of labor, materials and equipment necessary for the **Construction of Fuel Depot (10,000L) at Sangley Airport** which shall be done in accordance with the approved plans and specifications.

SPL-I MOBILIZATION/DEMOBILIZATION

This work includes mobilization and demobilization of the contractor's personnel and equipment necessary for performing the work required under the contract.

- a. Mobilization shall include all activities and associated costs for transportation of the contractor's personnel, equipment, and the establishment of offices and other necessary facilities for the contractor's operations at the site.
- b. Demobilization shall include the disassembly of offices and other facilities on the site, as well as the removal and hauling of debris and rubbish materials.
- c. **Miscellaneous Structure (Project Information Sign)**

The work includes labor, materials and performance of all operations to complete the installation of plumbing fixtures and accessories, sewer line, water line and storm drainage system as indicated on plans. (Materials to be used and workmanship must be approved by the Project-in-Charge designated by the CAAP).

In accordance with the COA Circular No. 2013-004 dated January 30, 2013. To promote good governance through transparency and accountability, infrastructure projects shall have a tarpaulin



Republic of the Philippines

CIVIL AVIATION AUTHORITY OF THE PHILIPPINES

signboard, suitability framed for outdoor display at the project location, and shall have the following specifications:

- a. White, 4ft by 8ft in size
- b. Resolution: 70 dpi
- c. Font: Helvetica
- d. Font Size: Main Information- 3"; Sub Information-1"
- e. Font Color: Black"

In compliance with the Proclamation Np. 486, S.2024 project billboards shall bear the message, "This is Where Your Taxes Go", to be placed above or below the project billboards. The design and format of the tarpaulin shall have the following specifications:

- a. White, 4ft by 1ft in size
- b. Resolution: 70 dpi
- c. Font: Helvetica
- d. Font Size: Main Information- 6"
- e. Font Color: Black"

I. CIVIL/STRUCTURAL WORKS

1.01 Demolition Works

The work includes all materials, labor, equipment for demolition and clearing the construction site to complete the demolition of existing slab

1.01a Utilities

The contractor shall protect and maintain all conduits, drains, sewer pipes and other utility services that are to remain on the property

1.02 Concrete Works

The work includes all materials, labor and equipment for the construction of footings, columns, beams, wall footings and slab of covered area including cut, bend & place of reinforced steel bars and formworks & scaffolding as specified on the plans.

A. Standard Specifications and Codes

The work covered by this section unless otherwise specified or detailed, shall be governed by the Building Code requirements for Reinforced Concrete (ACI 318), Standard code for ARC, Gas welding society. The latest edition of all standards specifications or codes will be used.

B. Coordination



The concrete work shall be coordinated with the work of trades to allow reasonable time to set sleeves, Inserts and other accessories which

must be in position before concrete bases and pads of mechanical equipment shall be placed to comply with approved shop drawings for the equipment.

1.02.a Inspection

No pouring of concrete shall be done by the contractor unless the bearing surfaces has been inspected and approved by Engineer, and the authority to proceed has been received by the contractor.

1.02.b Material Requirements

1.02b.1 Portland Cement

Portland Cement shall conform to the requirements of ASTM C-150 Type for normal Portland Cement; Type III for Highly Early Strength Portland Cement. Cement shall be any standard commercial brand in 40 kgs per bag.

1.02b.2 Fine Aggregates

Sand shall be clean, hard, coarse river sand or crush sand free from injurious amount of clay and vegetable matter shall conform to ASTM C-33 or C-330.

1.02b.3 Coarse Aggregate

Gravel shall be river run gravel or broken stone. The maximum size shall be 1/5 of the nearest dimension between sides of forms of the concrete, or 3/4 of the minimum clear spacing between reinforcing bars, or between re-bars and forms which ever is smaller.

1.02b.4 Mixing Water

Water used in mixing concrete shall be clean and free from injurious amount of oils, acids, alkali, organic materials or other deleterious substances.

1.02b.5 Admixture

All air-entraining admixtures if used, shall conform to ASTM C-260. Water reducing admixtures, retarding admixtures, and water reducing



and accelerating admixture, if used, shall conform to the requirements of ASTM C-494.

1.02.c Proportioning of Concrete

The contractor shall employ, at his own expense, as approved testing, laboratory which shall design the mix for each type of concrete required by the specifications and drawings to obtain strength as determined by test cylinder at least 15% higher than required. Strength requirements shall be as noted on the drawings.

1.02.d Concrete Test

A. Testing Laboratory and Reports

The contractor shall employ at his own expense, as approved testing laboratory which shall make compression and slump test and immediately submit 5 copies of the test reports to the supervising Architect or Engineer.

1.02e Curing and Protection

All concrete work shall be protected from drying out after removal of forms by covering with waterproof paper, polyethylene sheeting, burlap, with a coating of approved membrane curing compound having a moisture retention equal to 90% based on ATM C-309 and C-156, applied in accordance with the manufacturer's instruction for use.

1.02.f Metal Reinforcement

Reinforcing Steel Bar shall conform to ASTM specifications A-615. All Mild steel for columns, shear wall, footings and footing beam shall be intermediate grade deformed bars. $F_y = 275.8$ Mpa.

All reinforcement shall be placed according to the approved drawings. The contractor shall provide sufficient bar support, ties, anchors and other accessories to hold all bars securely in place. Provide Bar support and other accessories necessary to hold reinforcing bars in the proper positions while concrete is being placed. Bar support which come in contact with forms for concrete exposed to view in the finished structure shall be galvanized or stainless subject to approval.



1.02.g Placing of Reinforcement

All reinforcement shall be placed according to the approved drawings. The contractor shall provide sufficient bar supports, ties and other accessories to hold all bars securely in place.

Unless detailed on drawings, all stirrups shall be held in place by bar spacer. Reinforcing steel shall be cleaned of oil, grease, scale, rust or other coatings which will impair bond.

1.02. h Forms

Forms shall conform to the shape, lines and dimensions shown on the drawings. They shall be substantial and designed to resist the pressure and weight of the concrete.

Forms shall be properly tied and braced or shored so as to maintain their position and shapes. Forms shall be sufficiently tight and strong to prevent leakage of mortar.

Remove forms and form tie ends then fill holes with 1:2 Portland Cement mortar mixed to match the concrete. All defective areas below grade line not exposed to view shall be patched with portland cement mortar mixed to match the concrete mixture as directed by the supervising Architect or Engineer.

1.03 Steel Works

The work includes furnishing of all materials, labor, tools, equipment, and performance of all operations relative to the fabrication, delivery to site, erection and painting of structural steel structure and purlins as shown on plans.

All Structural steel shall be in accordance with AISC Specification for the design, Fabrication and erection of structural steel for buildings. Materials and parts necessary to complete each item through such work is not shown or specified shall be included, such as bolts, welding rods etc.

1.04 Structural Epoxy Application

1.04.a Structural Epoxy Application for Bolts

The work shall consist of drilling, cleaning of holes and application of structural epoxy adhesive prior to insertion of bolts.

Structural epoxy must be suitable for cracked and non-cracked concrete in C 20/25 concrete mixture, high loading capacity and suitable for dry and water saturated concrete. In addition, structural epoxy must have the following design characteristics when using a 16mm dia. bolt with 160mm embedment.

Design Characteristics:

Concrete (C 20/25)	Permissible Tension	Shear
Non-crack	46 kN	32.2 kN
Crack	33.2 kN	32.2 kN

Required Methodology of Application

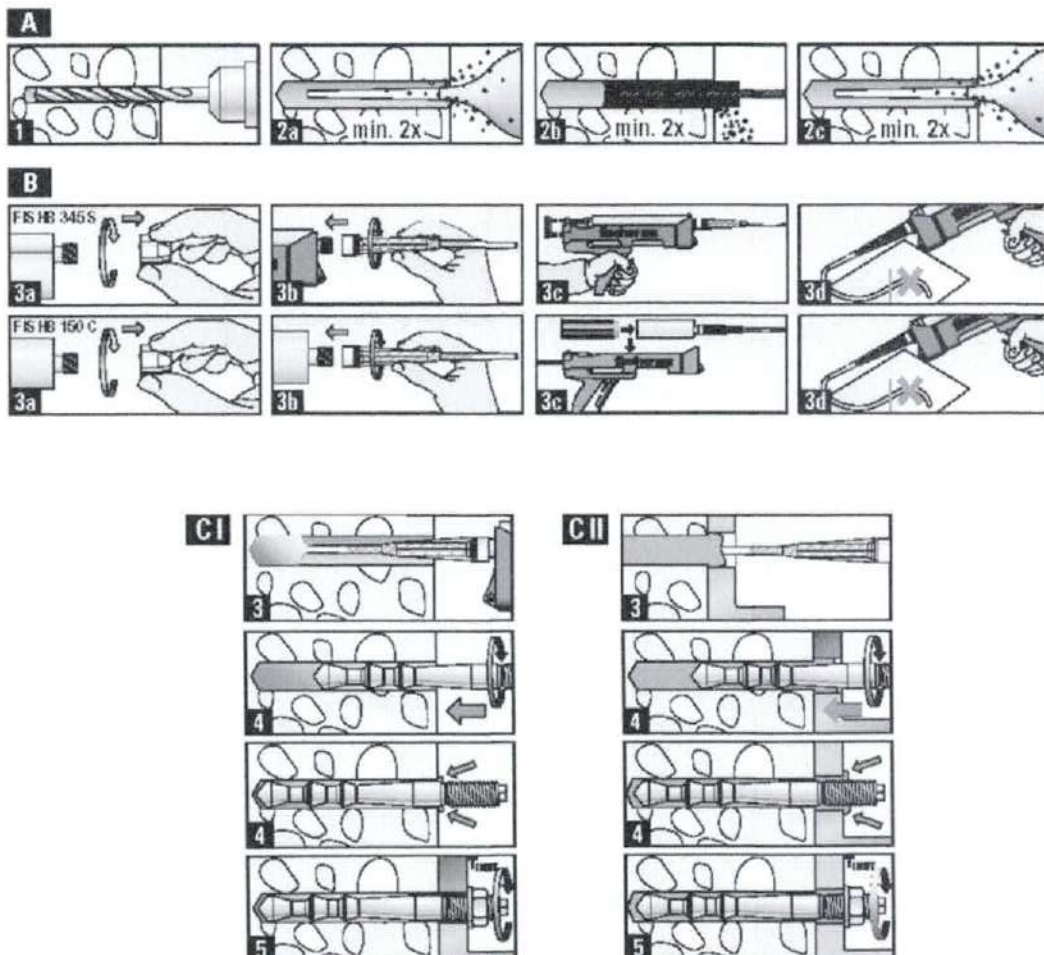



II. ARCHITECTURAL WORKS

2.01 Roofing Works

The work shall consist of furnishing all pre-painted metal sheet, equipment, tools, materials and labor required in undertaking the proper installation complete as shown on the Plans and in accordance with this specifications.

2.02 Painting Works

The work includes materials, tools, labor and equipment to complete the painting of interior and exterior walls, ceiling, and exterior overhang as shown on the plans and in accordance with this specifications.

The material and workmanship provided under this item shall be guaranteed by the contractor for a period of 1 year from the time of final inspection and acceptance of the work in writing by the supervising Architect. Any defective materials or workmanship shall be replaced and corrected by the contractor without extra cost to the owner.

III. ELECTRICAL WORKS

The work includes materials, labor and equipment to complete the installation of the following; Lighting and Power Conduits & Fittings; Wires & Cables; Electrical Wiring Devices; Lighting Fixtures; Boxes & pull boxes; Panel boards/Circuit Breaker; Feeder/Sub Feeder Conductor; Feeder/Sub Feeder conduit and fittings; ACU Conduits & Fittings; ACU wires and cable; Data and Telephone System; Grounding system; Termination accessories, hangers and supports and other miscellaneous materials as indicated on the plan. Electrical works should be tested and commissioned.

A handwritten signature in blue ink, appearing to be 'GZ', is located at the bottom right of the page.



IV. MECHANICAL WORKS

The work under this item shall consist of furnishing, supply and installation of all required materials, tools, equipment, and labor necessary for the satisfactory completion of works in strict accordance with applicable drawings, details and these specifications.

4.01 Fuel Tanks and Fuel Pump Requirements

4.01.a Fuel Tank

The fuel tank shall have the capacity of 10,000 liters constructed with 6.0mm SM Plate, 1.9 m inside diameter, including built-in metal stand, steel tank ladder and 3/4 transparent hose indicator and painting, delivery, lifting services, and installation.

Plant leak test and/or pneumatic test report shall be conducted prior to acceptance at the contractor's expense.

4.01.b Fuel Pump

The Electric fuel pump shall have the minimum power of 0.75hp to draw fuel from the storage tank and supply it to the engine at the correct pressure and flow rate, enabling combustion and power generation.

4.02 Piping Works

The item shall consist of furnishing all materials shown on the Plans for the satisfactory performance of the entire plumbing system including installation in accordance with the latest edition of the National Plumbing Code and this specifications.

All piping materials, and fittings accessories whether specifically mentioned or not but necessary to complete this item be furnished and installed.

Prepared By:

HEHERSON F. DOMINGO

Engineer – Area Center III



CAA AIRPORT AUTHORITY OF THE PHILIPPINES

THIS DRAWING IS AN EXCLUSIVE PROPERTY OF CAA AND IS NOT TO BE REPRODUCED, COPIED, TRANSMITTED, OR USED IN ANY MANNER WITHOUT THE WRITTEN CONSENT OF CAA. THE CAA DIRECTOR GENERAL IS NOT RESPONSIBLE FOR ANY DAMAGE OR LOSS OF PROFITS INCURRED BY ANY PARTY AS A RESULT OF THE USE OF THIS DRAWING.

AERODROME DEVELOPMENT AND MANAGEMENT SERVICE

INFRASTRUCTURE DEVELOPMENT AND DESIGN DIVISION

DESIGN STAFF	INITIAL DATE
DESIGNER: HFD	
CHECKER: HFD	
APPROVER: HFD	

REVIEWED BY:

[Signature]
GLENN O. BELLO
 Acting Chief Planning and Engineering, A-C-B
 PREPARED BY:

[Signature]
HERNANDEZ DOMINGO
 Engineer, Airport Group II
 RECOMMENDED APPROVAL:

[Signature]
BENNY F. DUCLOS III
 ACTING AIRPORT SUPERVISOR
 APPROVED:

[Signature]
[Name]
 Chief Engineer
 NOTES: REVISIONS

PROJECT TITLE
CONSTRUCTION OF FUEL SERVICE BUILDING AT SANGLEY AIRPORT
 LOCATION
SANGLEY POINT AIRPORT
 CLIENT'S NAME

SHEET CONTENTS
 IN SHEETS

DRAWING SCALE	SHEET NO.
AS SHOWN	S 02

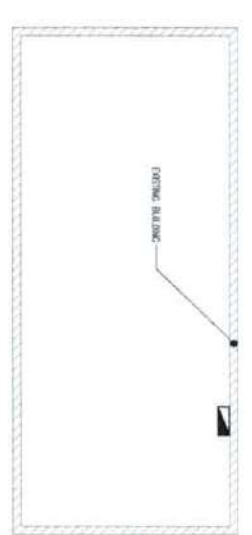
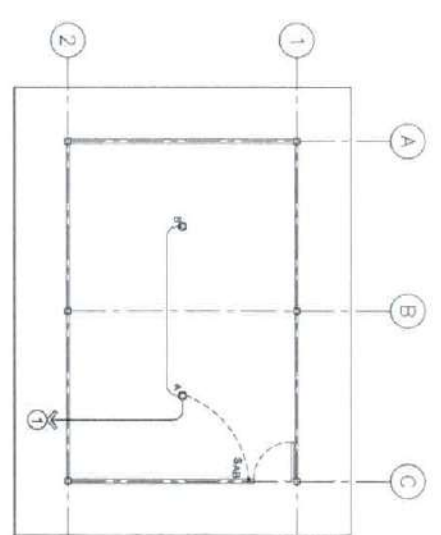

LEGEND:

- A O USURNG
- SAB 3-1/2" DIA SWITCH
- ▣ PANEL BOARD
- ① CIRCUIT NUMBER

2 LIGHTING LAYOUT
 SCALE 1:500

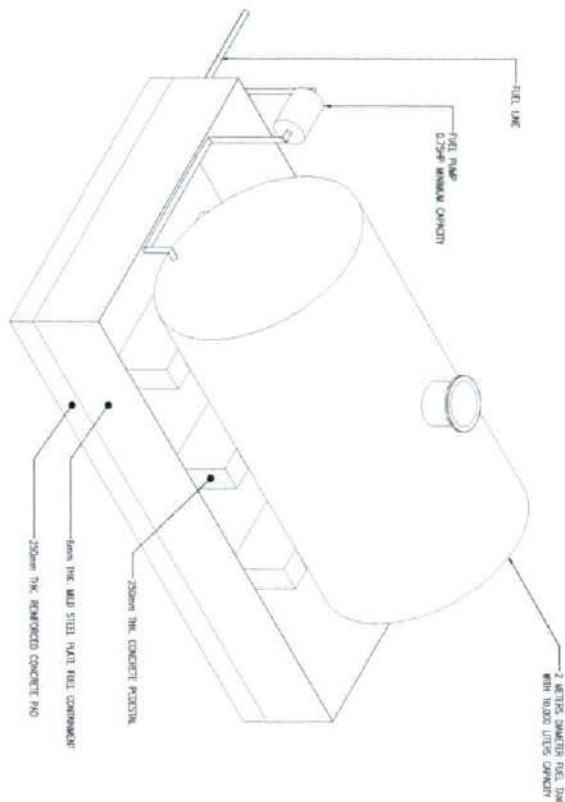

1 ISOMETRIC VIEW
 SCALE 1:200

Omnibus Sworn Statement (Revised)

[shall be submitted with the Bid]

REPUBLIC OF THE PHILIPPINES)
CITY/MUNICIPALITY OF _____) S.S.

AFFIDAVIT

I, [Name of Affiant], of legal age, [Civil Status], [Nationality], and residing at [Address of Affiant], after having been duly sworn in accordance with law, do hereby depose and state that:

1. *[Select one, delete the other:]*

[If a sole proprietorship:] I am the sole proprietor or authorized representative of [Name of Bidder] with office address at [address of Bidder];

[If a partnership, corporation, cooperative, or joint venture:] I am the duly authorized and designated representative of [Name of Bidder] with office address at [address of Bidder];

2. *[Select one, delete the other:]*

[If a sole proprietorship:] As the owner and sole proprietor, or authorized representative of [Name of Bidder], I have full power and authority to do, execute and perform any and all acts necessary to participate, submit the bid, and to sign and execute the ensuing contract for [Name of the Project] of the [Name of the Procuring Entity], as shown in the attached duly notarized Special Power of Attorney;

[If a partnership, corporation, cooperative, or joint venture:] I am granted full power and authority to do, execute and perform any and all acts necessary to participate, submit the bid, and to sign and execute the ensuing contract for [Name of the Project] of the [Name of the Procuring Entity], as shown in the attached [state title of attached document showing proof of authorization (e.g., duly notarized Secretary's Certificate, Board/Partnership Resolution, or Special Power of Attorney, whichever is applicable)];

3. [Name of Bidder] is not "blacklisted" or barred from bidding by the Government of the Philippines or any of its agencies, offices, corporations, or Local Government Units, foreign government/foreign or international financing institution whose blacklisting rules have been recognized by the Government Procurement Policy Board, **by itself or by relation, membership, association, affiliation, or controlling interest with another blacklisted person or entity as defined and provided for in the Uniform Guidelines on Blacklisting;**

4. Each of the documents submitted in satisfaction of the bidding requirements is an authentic copy of the original, complete, and all statements and information provided therein are true and correct;

5. [Name of Bidder] is authorizing the Head of the Procuring Entity or its duly authorized representative(s) to verify all the documents submitted;

6. *[Select one, delete the rest:]*

[If a sole proprietorship:] The owner or sole proprietor is not related to the Head of the Procuring Entity, members of the Bids and Awards Committee (BAC), the Technical

Working Group, and the BAC Secretariat, the head of the Project Management Office or the end-user unit, and the project consultants by consanguinity or affinity up to the third civil degree;

[If a partnership or cooperative:] None of the officers and members of *[Name of Bidder]* is related to the Head of the Procuring Entity, members of the Bids and Awards Committee (BAC), the Technical Working Group, and the BAC Secretariat, the head of the Project Management Office or the end-user unit, and the project consultants by consanguinity or affinity up to the third civil degree;

[If a corporation or joint venture:] None of the officers, directors, and controlling stockholders of *[Name of Bidder]* is related to the Head of the Procuring Entity, members of the Bids and Awards Committee (BAC), the Technical Working Group, and the BAC Secretariat, the head of the Project Management Office or the end-user unit, and the project consultants by consanguinity or affinity up to the third civil degree;

7. *[Name of Bidder]* complies with existing labor laws and standards; and
8. *[Name of Bidder]* is aware of and has undertaken the responsibilities as a Bidder in compliance with the Philippine Bidding Documents, which includes:
 - a. Carefully examining all of the Bidding Documents;
 - b. Acknowledging all conditions, local or otherwise, affecting the implementation of the Contract;
 - c. Making an estimate of the facilities available and needed for the contract to be bid, if any; and
 - d. Inquiring or securing Supplemental/Bid Bulletin(s) issued for the *[Name of the Project]*.
9. *[Name of Bidder]* did not give or pay directly or indirectly, any commission, amount, fee, or any form of consideration, pecuniary or otherwise, to any person or official, personnel or representative of the government in relation to any procurement project or activity.
10. **In case advance payment was made or given, failure to perform or deliver any of the obligations and undertakings in the contract shall be sufficient grounds to constitute criminal liability for Swindling (Estafa) or the commission of fraud with unfaithfulness or abuse of confidence through misappropriating or converting any payment received by a person or entity under an obligation involving the duty to deliver certain goods or services, to the prejudice of the public and the government of the Philippines pursuant to Article 315 of Act No. 3815 s. 1930, as amended, or the Revised Penal Code.**

IN WITNESS WHEREOF, I have hereunto set my hand this ___ day of ___, 20__ at _____, Philippines.

[Insert NAME OF BIDDER OR ITS AUTHORIZED REPRESENTATIVE]

[Insert signatory's legal capacity]

Affiant

[Jurat]

[Format shall be based on the latest Rules on Notarial Practice]